

133
FEDERAL
STREET

RETAIL/RESTAURANT
OPPORTUNITY

3,300 SF

TRANS NATIONAL

BRICK
CROSSFIT

NEWMARK

FINANCIAL DISTRICT AREA STATS



DAYTIME EMPLOYEES
182,000
(1/2 mile)



HIGHEST CONCENTRATION
OF EMPLOYEES IN BOSTON
33M SF OFFICE
(1/2 Boston total office SF)



8,844 BUSINESSES
(WITHIN A 1/2 MILE RADIUS)

STEPS FROM...



112,800 RIDERS PER DAY

SOUTH STATION
NEW ENGLAND'S LARGEST
AND BUSIEST
TRANSPORTATION HUB



1.5M VISITORS
2015

ROSE KENNEDY GREENWAY

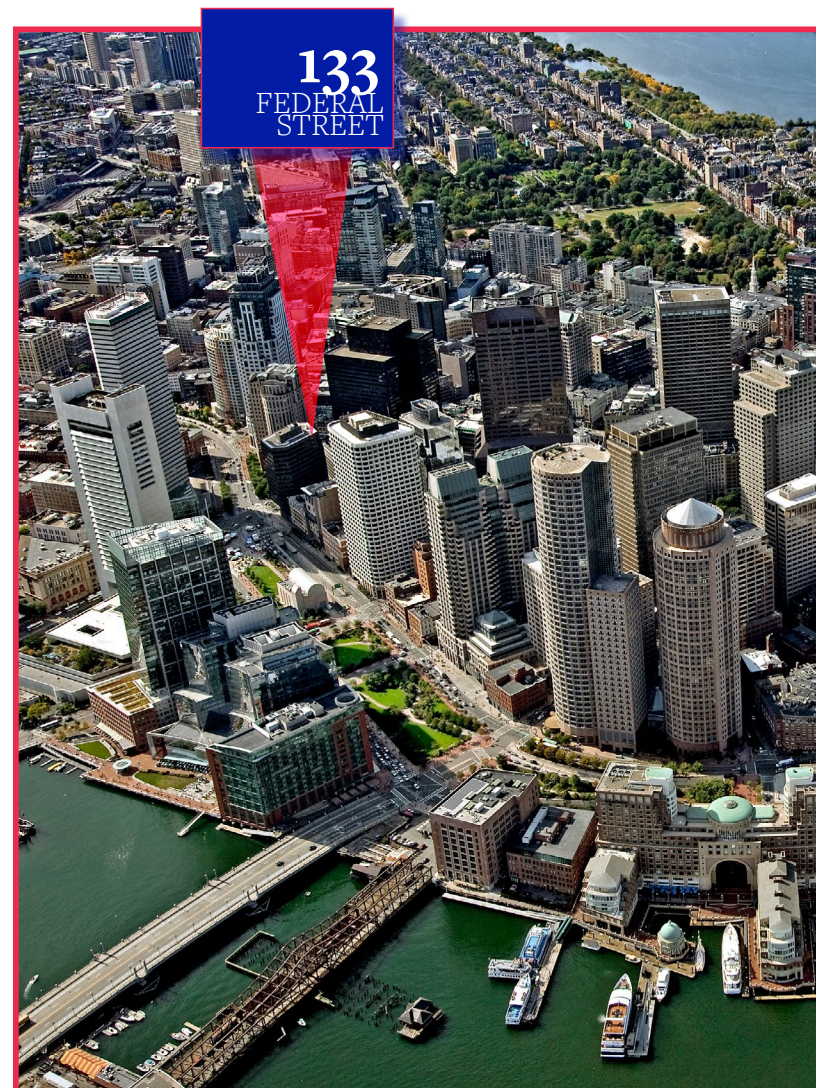

NEW OFFICE TENANTS IN THE MARKET



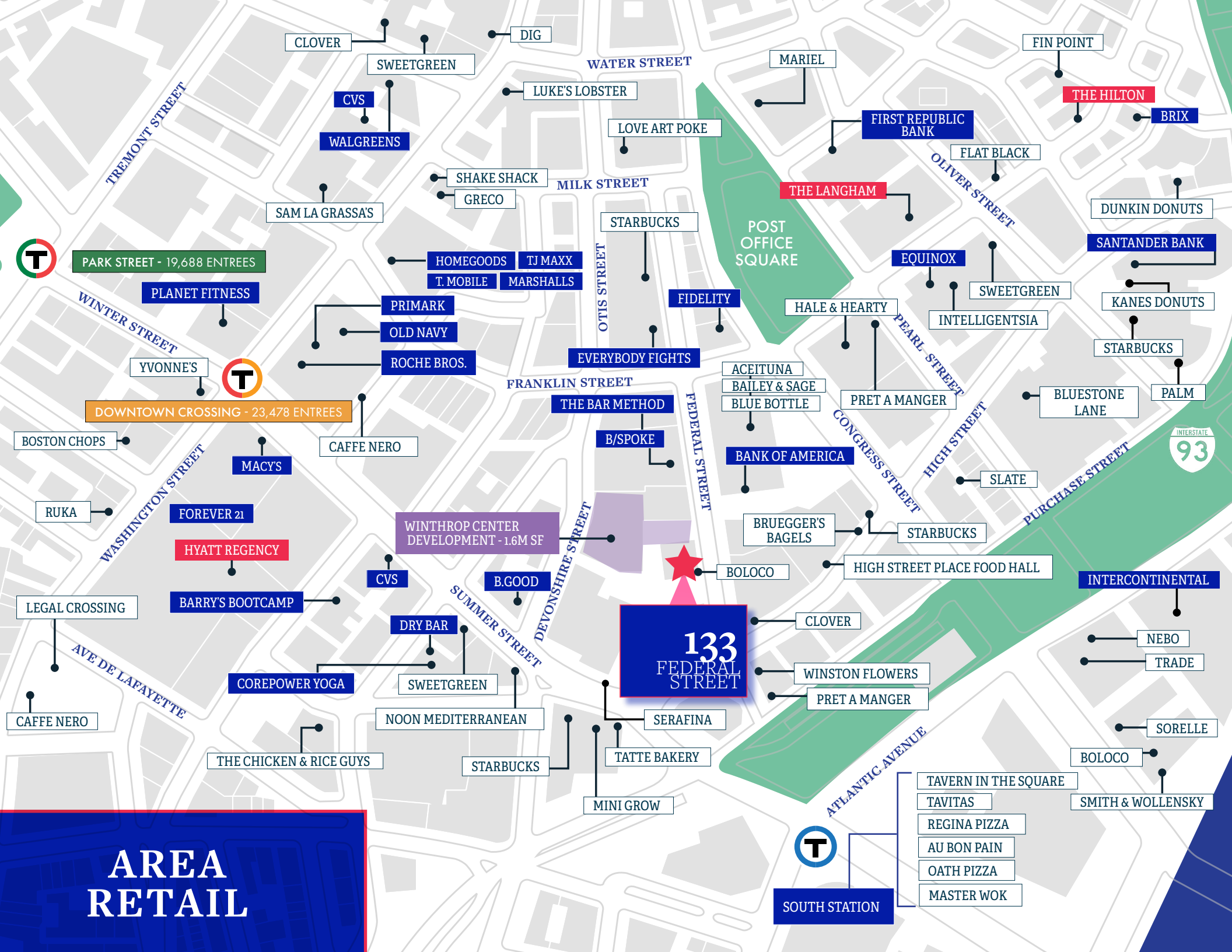

**AREA
RETAIL**

**133
FEDERAL
STREET**

T
SOUTH STATION

INTERSTATE
93

T

T

PARK STREET - 19,688 ENTREES

DOWNTOWN CROSSING - 23,478 ENTREES

WINTHROP CENTER
DEVELOPMENT - 1.6M SF

- TAVERN IN THE SQUARE
- TAVITAS
- REGINA PIZZA
- AU BON PAIN
- OATH PIZZA
- MASTER WOK

- CLOVER
- SWEETGREEN
- DIG
- WATER STREET
- MARIEL
- FIN POINT
- THE HILTON
- BRIX
- CVS
- LUKE'S LOBSTER
- LOVE ART POKE
- FIRST REPUBLIC BANK
- FLAT BLACK
- WALGREENS
- SHAKE SHACK
- MILK STREET
- THE LANGHAM
- GRECO
- STARBUCKS
- POST OFFICE SQUARE
- EQUINOX
- SANTANDER BANK
- SAM LA GRASSAS
- HOMEGOODS
- TJ MAXX
- DUNKIN DONUTS
- T. MOBILE
- MARSHALLS
- PLANET FITNESS
- PRIMARK
- OLD NAVY
- ROCHE BROS.
- EVERYBODY FIGHTS
- FIDELITY
- HALE & HEARTY
- INTELLIGENTSIA
- SWEETGREEN
- KANES DONUTS
- YVONNE'S
- CAFFE NERO
- THE BAR METHOD
- B/SPOKE
- ACEITUNA
- BAILEY & SAGE
- BLUE BOTTLE
- PRET A MANGER
- BLUESTONE LANE
- PALM
- BOSTON CHOPS
- MACY'S
- BANK OF AMERICA
- BRUEGGER'S BAGELS
- STARBUCKS
- SLATE
- RUKA
- FOREVER 21
- HYATT REGENCY
- CVS
- B.GOOD
- BOLOCO
- HIGH STREET PLACE FOOD HALL
- INTERCONTINENTAL
- LEGAL CROSSING
- BARRY'S BOOTCAMP
- Winston Flowers
- PRET A MANGER
- NEBO
- TRADE
- CAFFE NERO
- COREPOWER YOGA
- NOON MEDITERRANEAN
- SERAFINA
- SORELLE
- THE CHICKEN & RICE GUYS
- STARBUCKS
- TATTE BAKERY
- MINI GROW
- BOLOCO
- SMITH & WOLLENSKY

FLOOR PLANS

- Restaurant Ready
- Available Immediately

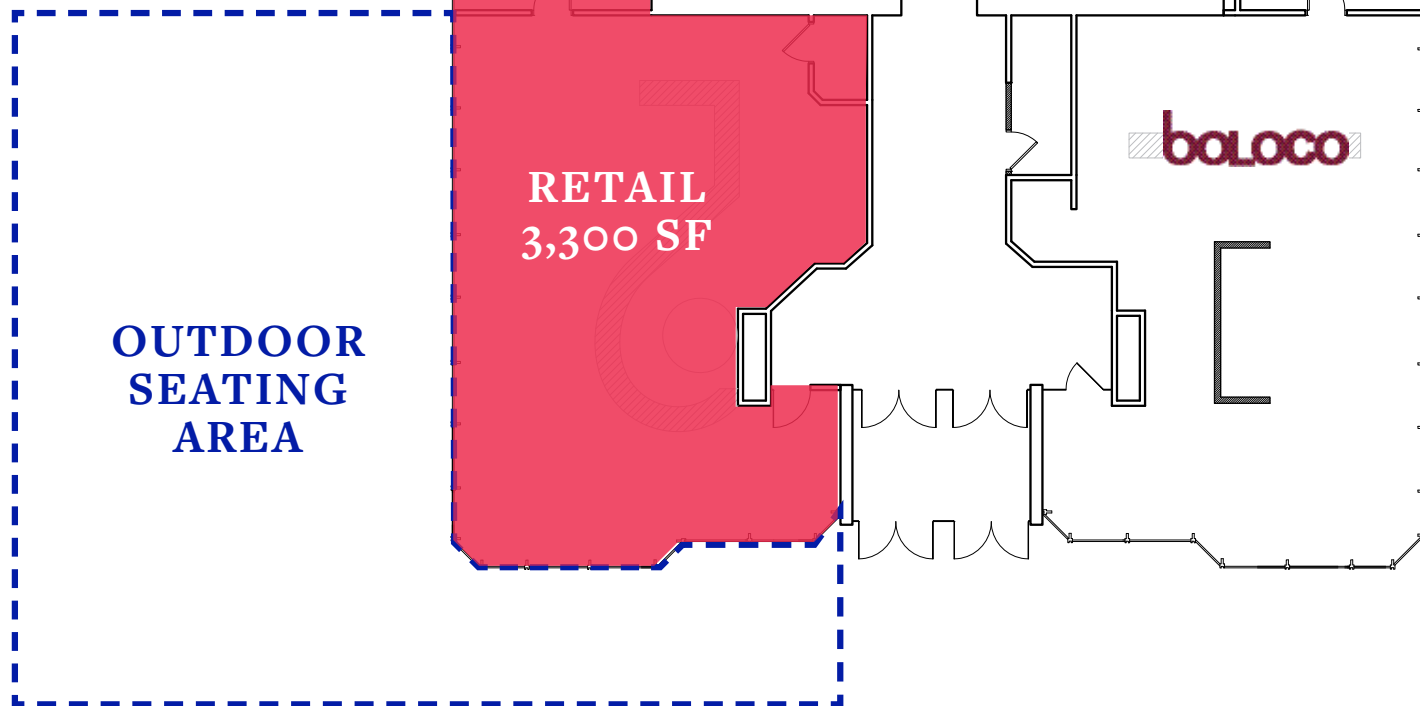

FEDERAL STREET

NEWMARK

JONATHAN MARTIN

617.772.7267

jzmartin@ngkf.com

PAT PALADINO

617.772.7266

ppaladino@ngkf.com